

Poulies dentées HTD® 8M-30 SERAX
HTD® tandriemschijven 8M-30 SERAX

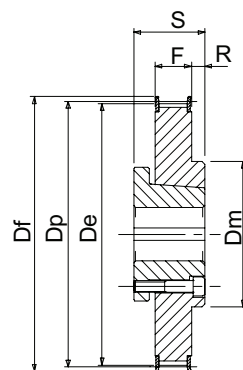
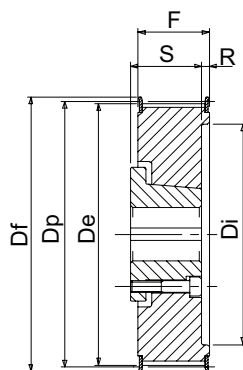
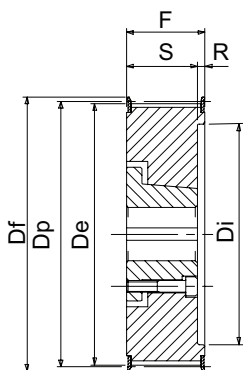
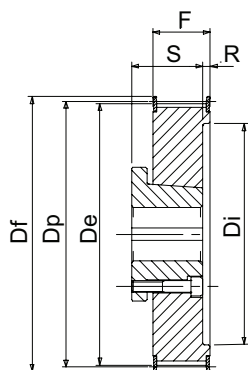

3AF

3F

3CF

2F

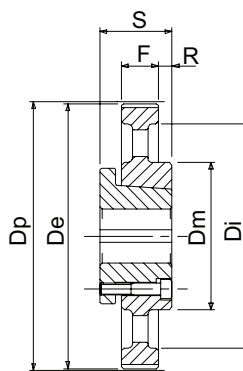
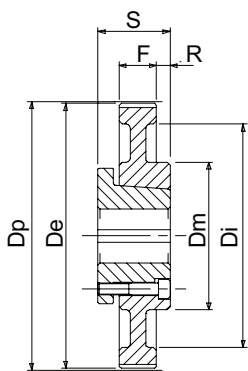

2B

2C

CODE	TYPE	MOYEU BUS	Z*	Dp	De	Df	Dm	Di	F	S	R	Kg	Caractéristiques Kenmerken	
B24-8M-30	3AF	2016	24	61,12	59,75	66	---	42	38	27	22	0,40	AVEC FLASQUES MET FLENZEN	ACIER STAAL
B26-8M-30	3F	2016	26	66,21	64,84	71	---	47	38	27	11	0,44		
B28-8M-30	3F	2016	28	71,30	70,08	75	---	49	38	27	11	0,54		
B30-8M-30	3AF	2825	30	76,39	75,13	83	---	58	38	37	13	0,67		
B32-8M-30	3F	2825	32	81,49	80,16	87	---	62	38	37	1	0,76		
B34-8M-30	3AF	3825	34	86,58	85,22	91	---	65	38	37	13	0,75		
B36-8M-30	3CF	3825	36	91,67	90,30	98,5	---	71	38	37	6	0,98		
B38-8M-30	3CF	3825	38	96,77	95,39	103	---	72	38	37	6	1,04		
B40-8M-30	3CF	3825	40	101,86	100,49	106	---	76	38	37	6	1,20		
B44-8M-30	3CF	4830	44	112,05	110,67	119	---	91	38	45	4	1,38		
B48-8M-30	3CF	4830	48	122,23	120,86	127	---	95	38	45	4	1,83		
B56-8M-30	3CF	4830	56	142,60	141,23	148	---	117	38	45	4	2,75		
B64-8M-30	2F	6045	64	162,97	161,60	168	135	---	38	63	7	4,50	SANS FLASQUES ZONDER FLENZEN	FONTE GIETIJZER
B72-8M-30	2F	6045	72	183,35	181,97	192	140	---	38	63	7	6,00		
B80-8M-30	2B	6045	80	203,72	202,35	---	140	180	38	63	7	5,40		
B90-8M-30	2B	6045	90	229,18	227,81	---	140	204	38	63	7	6,20		
B112-8M-30	2C	6045	112	285,21	283,83	---	140	260	38	63	7	7,50		
B144-8M-30	2C	6045	144	366,69	365,32	---	140	341	38	63	7	9,80		

*Z= Nombre de dents / aantal tanden